

# GUEST HOUSE MEETING ROOM Information

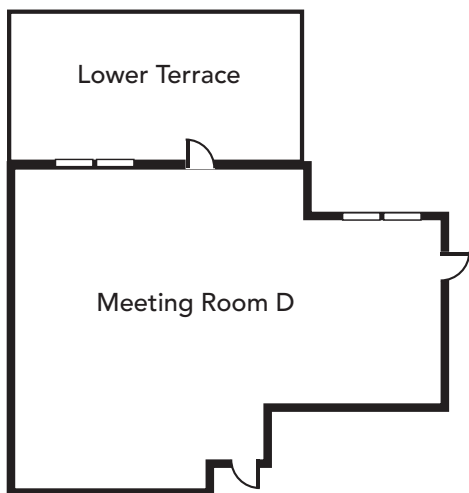
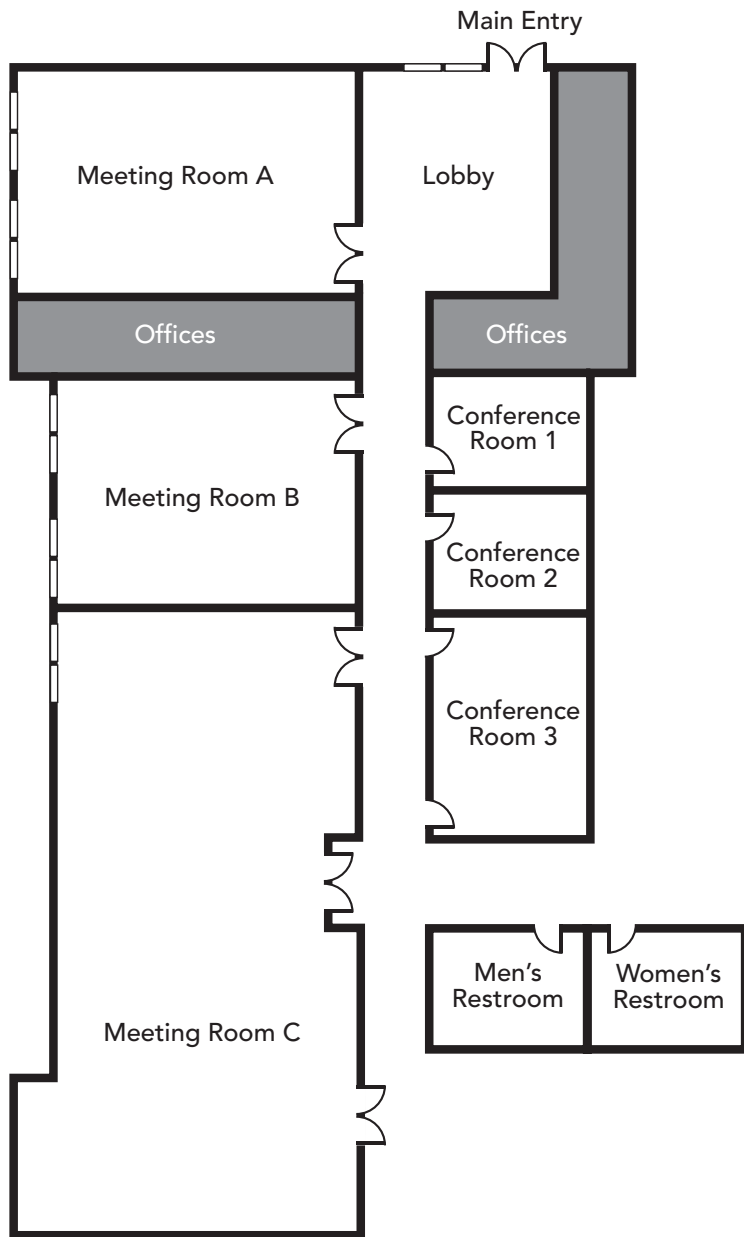

## Meeting Room A $24' \times 40' = 960$ sq. feet

- 52 Theatre Style
- 24 Classroom Style
- 16 U shaped
- 24 Hollow Square
- 36 Banquet

## Meeting Room B $24' \times 30' = 720$ sq. feet

- 52 Theatre Style
- 24 Classroom Style
- 16 U shaped
- 24 Hollow Square
- 36 Banquet

## Meeting Room C $90' \times 30' = 2700$ sq. feet

- 144 Theatre Style w/o center isle
- 130 Theatre Style with center isle
- 66 Classroom Style
- 38 U shaped
- 52 Hollow Square
- 102 Banquet

## Meeting Room D *irregular shape = 782* sq. feet

- 50 Theatre Style
- 24 Classroom Style
- 14 U shaped
- 22 Hollow Square
- 36 Banquet

*additional terrace with seating 20 people (5 rounds of 4)*

## Conference Room 1 $17' \times 12' = 204$ sq. feet

Conference table for 8

## Conference Room 2 $17' \times 12' = 204$ sq. feet

Conference table for 8

## Conference Room 3 $17' \times 24' = 408$ sq. feet

Conference table for 12

## Lobby Terrace $670$ sq. feet

11 Iron patio tables of 4

| Table         | People/Table | Dimension |
|---------------|--------------|-----------|
| Round         | 6 people     | 54"       |
| Round         | 8-10         | 60"       |
| 5' Conference | 2 people     | 5' x 24"  |
| 6' Conference | 2-3 people   | 6' x 24"  |
| 6' Classroom  | 2-3 people   | 6' x 18"  |

*Video, telephone and data ports in all meeting and conference rooms. White boards are in all meeting and conference rooms.*

